

SUNSET GOWER STUDIOS

Stage 7

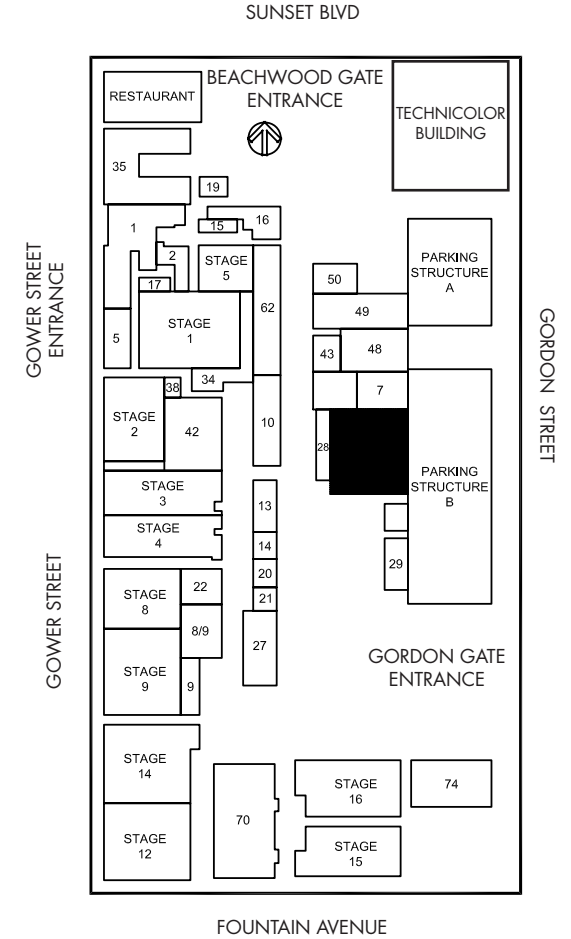

Width	Length	Height (Perms)	Total Stage Square Footage	Floor Type	Door (WxH)	Gross Weight Limit
106'9"	143'3"	29'	17,559	Concrete	11'11" x 17'	No Limit

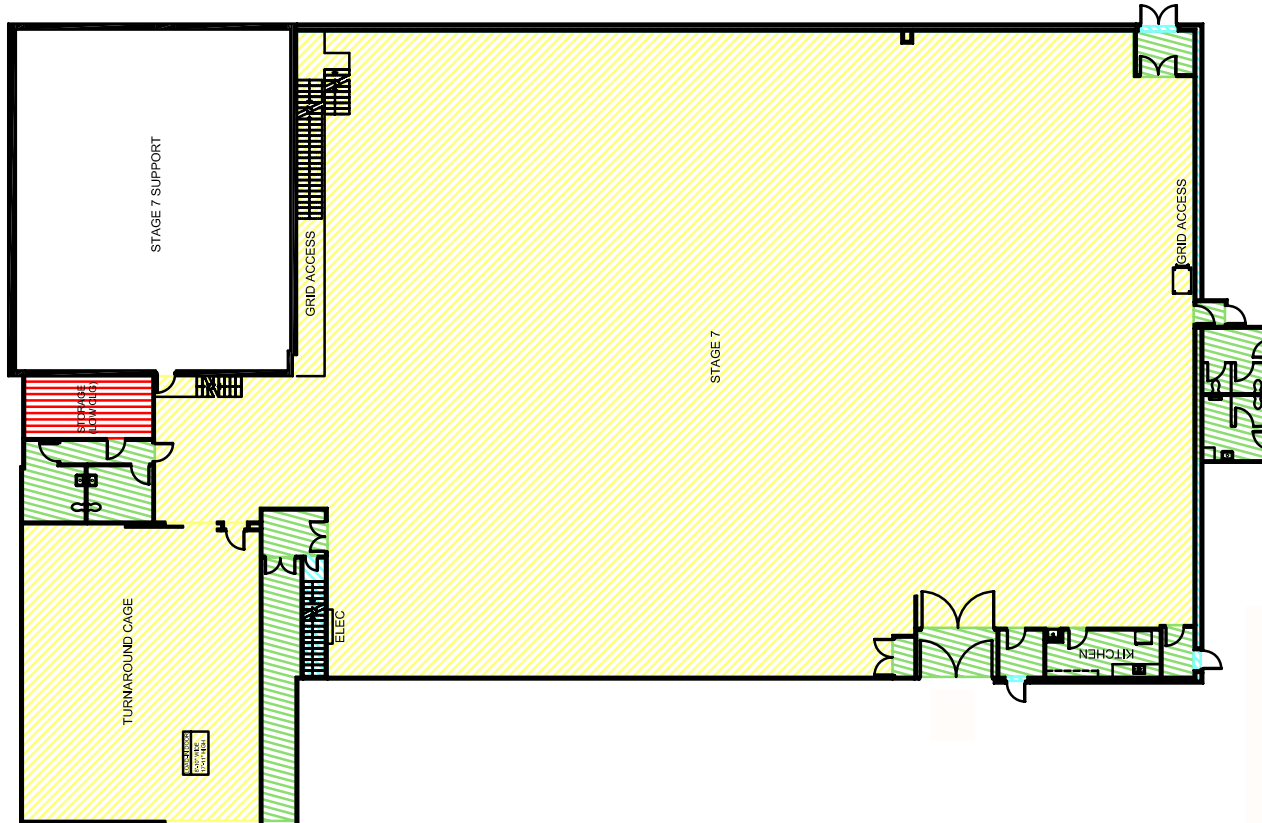
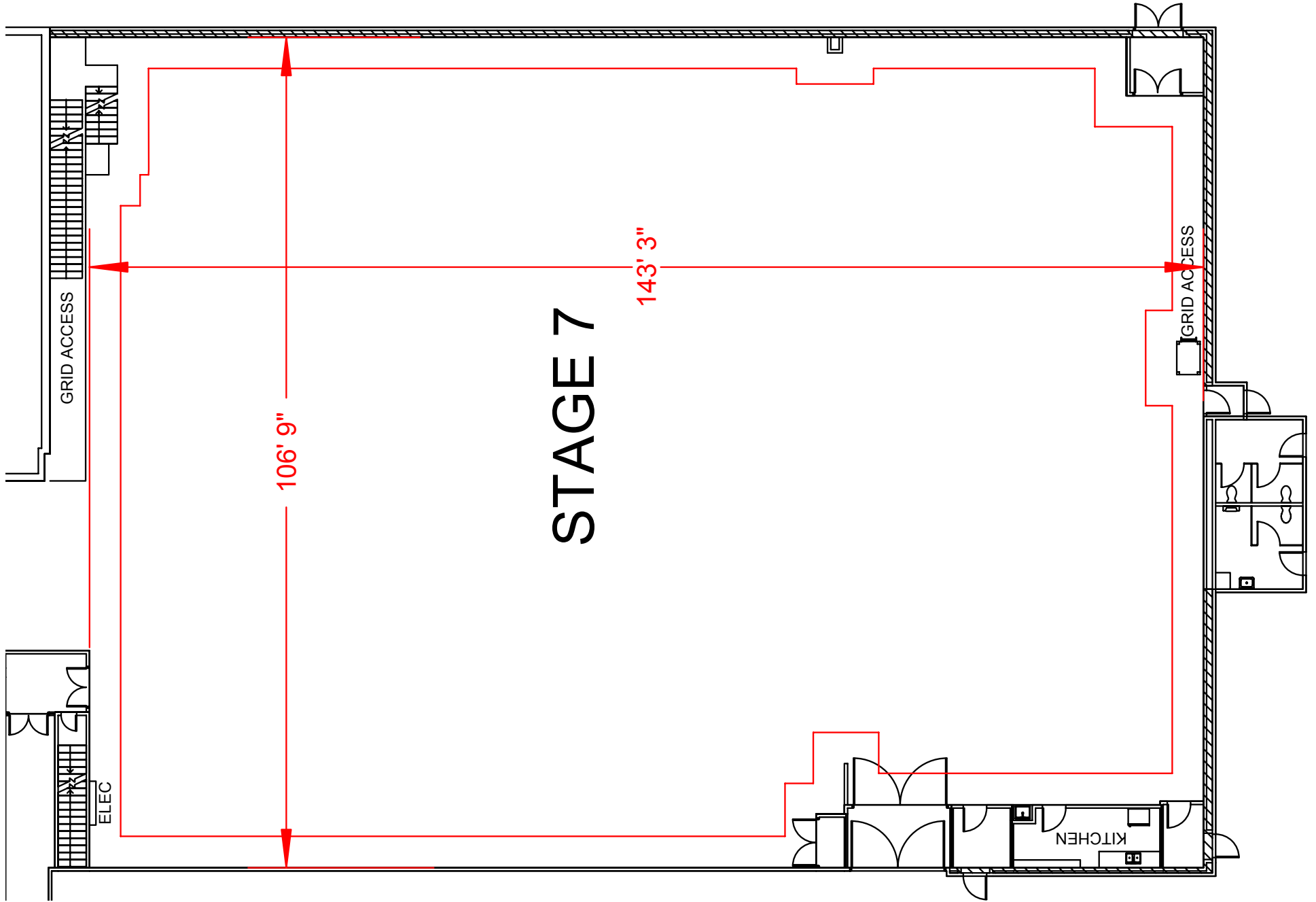

Stage Specifications: Stage 7

Sunset Gower Studios

Stage Specifications - (Dimensions Include 4' Fire Lane)

Width – 106' 9"

Length – 143' 3"

Height (Perms) – 29'

Total Square Footage – 17559

Floor Type – Concrete

Elephant Door (W X H) – 11' 11" X 17'

Gross Weight Limits - Unlimited

Support Space- (Available On Stage)

Kitchen on stage with fridge, stove.

Dressing Rooms, Wardrobe, and Hair + Make Up rooms are available in adjacent buildings

Heavy Equipment – (Authorized Lifts)

Unlimited

Electric Service

Production Power - 120/208 800 Amp Per Phase Bus Bar, 4800 Amp Total Standard. Additional 2400 Amps Available

240 Volts - No

480 Volts - No

Tech Power - Available

Power In Grid - Available (Single Phase 120/208)

HVAC

HVAC - (2) 30 Ton (Nominal) Cooling Only Package Units.

25 Ton (Nominal) Cooling Only Package Unit

25 Ton (Nominal) Cooling/Heat Package Unit

Redlight Control - Yes

Ventilation - Yes

Heating - Yes

Stage Extras

Hose Bib - No

Gas - No

Drain - Yes

Compressed Air - No

Wireless Internet – Available

Phone – Available

Fax – Available