

SUNSET BRONSON STUDIOS

Stage 2

SUNSET BLVD

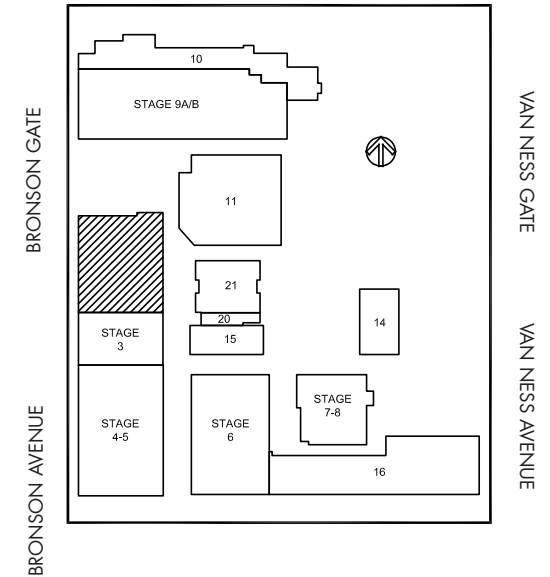
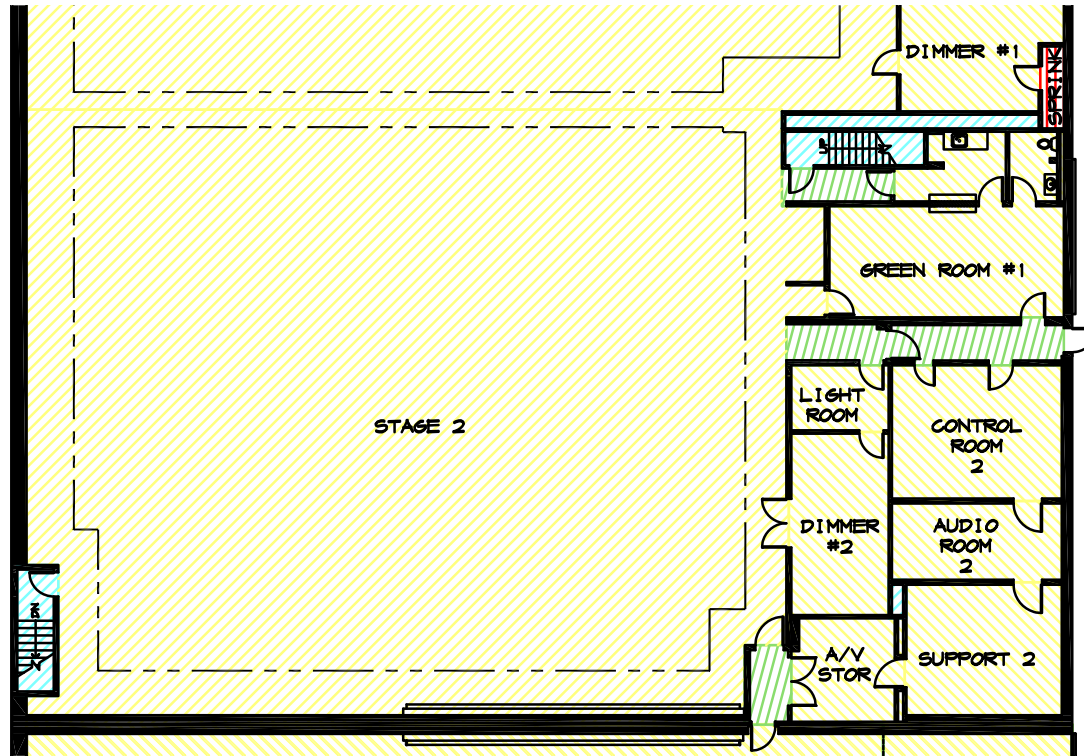

FERNWOOD AVENUE

Width	Length	Height (Perms)	Total Stage Square Footage	Floor Type	Door (WxH)	Gross Weight Limit
75' 1 1/8"	94' 1/8"	30'	6,935	Wood	19'2" X 16'3"	12,000 Lbs.

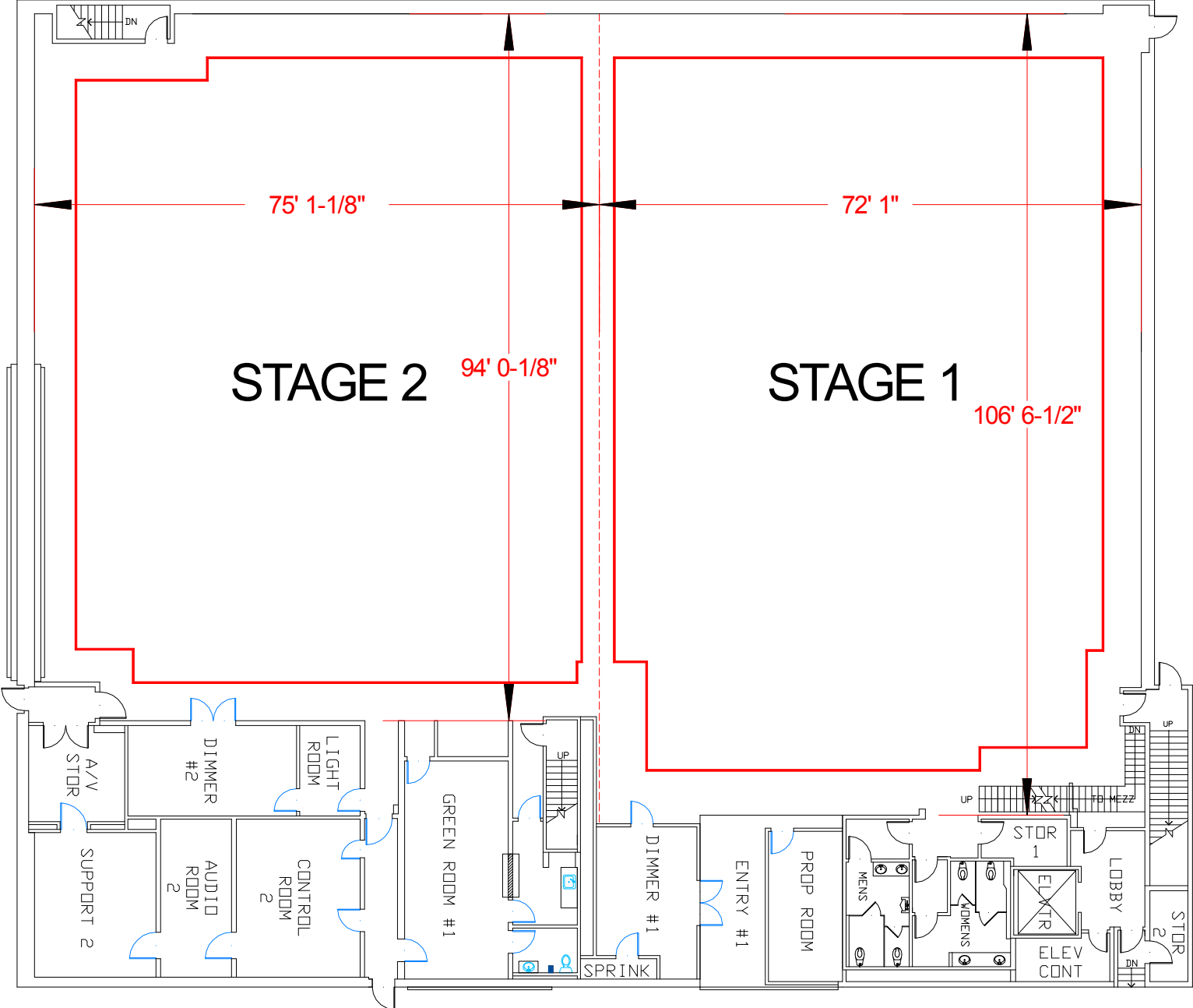

Stage Specifications: Stage 2

Sunset Bronson Studios

Stage Specifications - (Dimensions Include 4' Fire Lane)

Width – 75' 1 1/8"

Length – 94' 1/8"

Height (Perms) – 30'

Total Square Footage – 6935 sf

Floor Type – Wood

Elephant Door (W X H) – 19' 2" X 16' 3"

Gross Weight Limits - 12,000 lbs (No Load)

Full Service Control / Audio / Video Tape Room Available

Support Space- (Available On Stage)

Offices - 0

Dressing Rooms - 9

Make Up Rooms - 1

Wardrobe - 1

Greenrooms – 1 (2 Additional Upon Availability)

Galley - 1

Heavy Equipment – (Authorized Lifts)

32' Scissor – 3246ES

30' Articulating Boom – E300AJP

40' Articulation Boom – E400AJP

Electric Service

Production Power - 120/208 800 Amp Per Phase Bus Bar, 2400 Amp Total Standard. Additional 7200 Amps Available

240 Volts - Accessible

480 Volts - No

Tech Power - Available

Power In Grid - Available (Single Phase 120/208)

HVAC

HVAC- (3) 20 Ton (Nominal) Cooling Only Package Units.

Redlight Control - Yes

Ventilation - No

Heating – No

Stage Extras

Hose Bib - Yes

Gas - Yes; Compressed Air - No

Drain - Yes

Wireless Internet – Yes ; Phone – Yes ; Fax – No