

# SUNSET BRONSON STUDIOS

## Stage 1

SUNSET BLVD

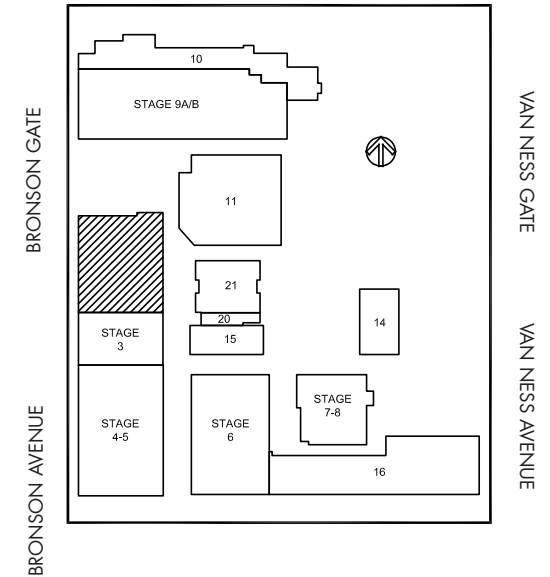
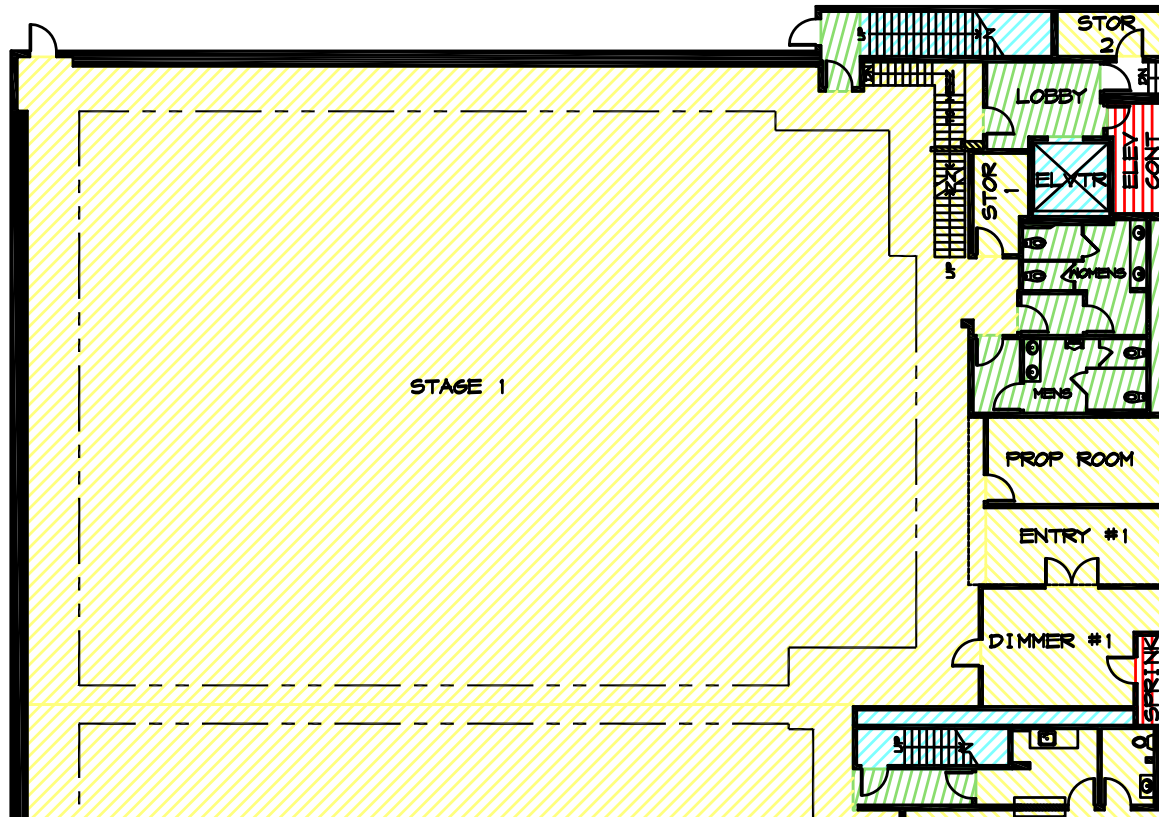

FERNWOOD AVENUE

Width	Length	Height (Perms)	Total Stage Square Footage	Floor Type	Door (WxH)	Gross Weight Limit
72'1"	106' 6 1/2"	30'	7,655	Wood	18'10" x 16'4"	12,000 Lbs.

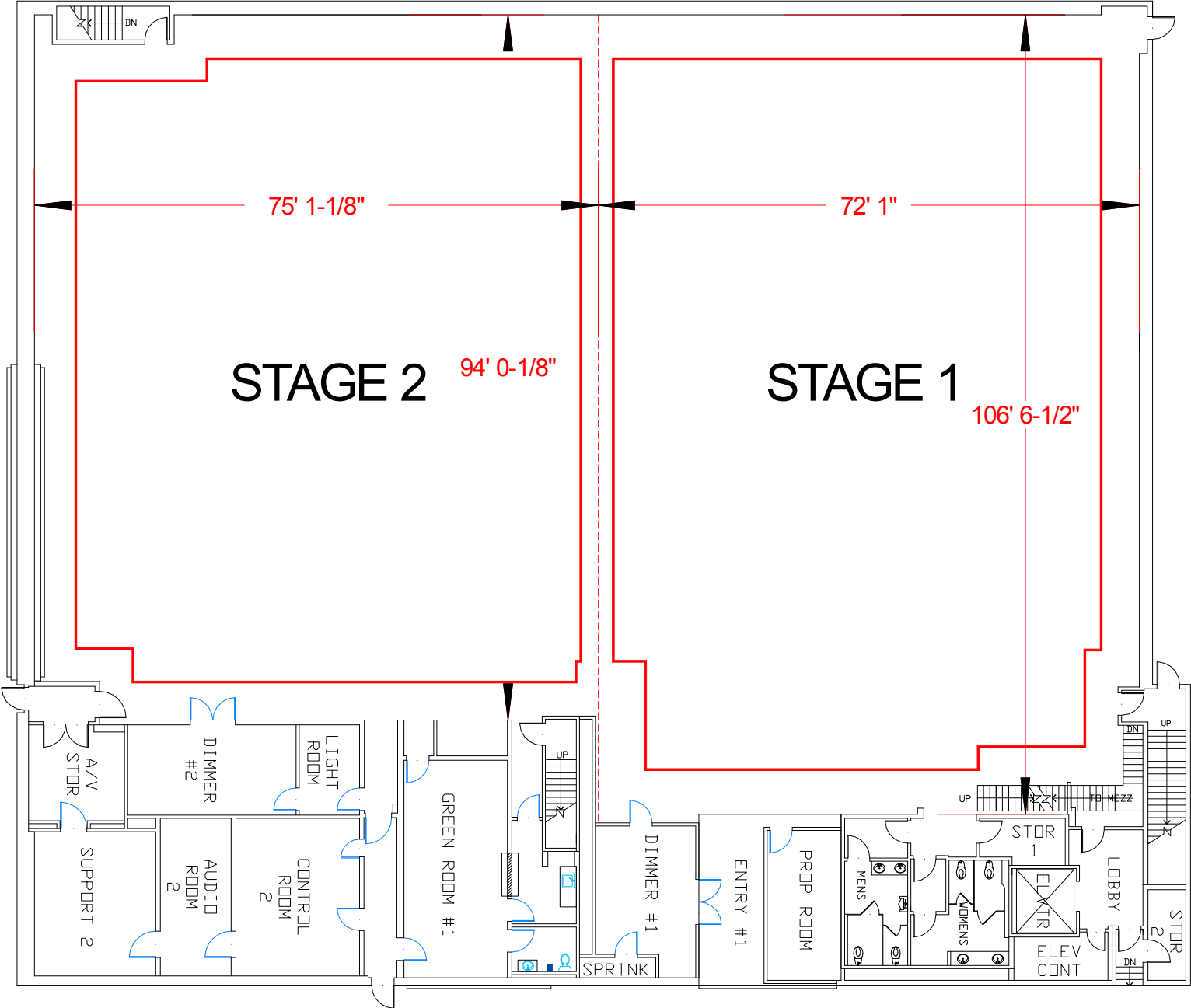

# Stage Specifications: Stage 1

Sunset Bronson Studios

---

## **Stage Specifications - (Dimensions Include 4' Fire Lane)**

Width – 72'1"

Length – 106' 6 1/2"

Height (Perms) – 30'

Total Square Footage – 7655 sf

Floor Type – Wood

Elephant Door (W X H) – 18' 10" X 16' 4"

Gross Weight Limits - 12,000 lbs (No Load)

Full Service Control / Audio / Video Tape Room Available

## **Support Space- (Available On Stage)**

Offices – 1

Dressing Rooms – 9

Make Up Rooms – 1

Wardrobe - 1

Greenrooms – 1 (2 Additional Upon Availability)

Galley - 1

## **Heavy Equipment – (Authorized Lifts)**

32' Scissor – 3246ES

30' Articulating Boom – E300AJP

40' Articulation Boom – E400AJP

## **Electric Service**

Production Power - 120/208 800 Amp Per Phase Bus Bar, 2400 amp total standard. Additional 2400 Amps Available

240 Volts – No

480 Volts – No

Tech Power – Available

Power In Grid – Available (Single Phase 120/208)

## **HVAC**

HVAC- (3) 20 Ton (Nominal) Cooling Only Package Units.

Redlight Control – Yes

Ventilation – No

Heating – No

## **Stage Extras**

Hose Bib – Yes

Gas – Yes ; Compressed Air – No

Drain – No

Wireless Internet – Yes; Phone – Yes; Fax – No